

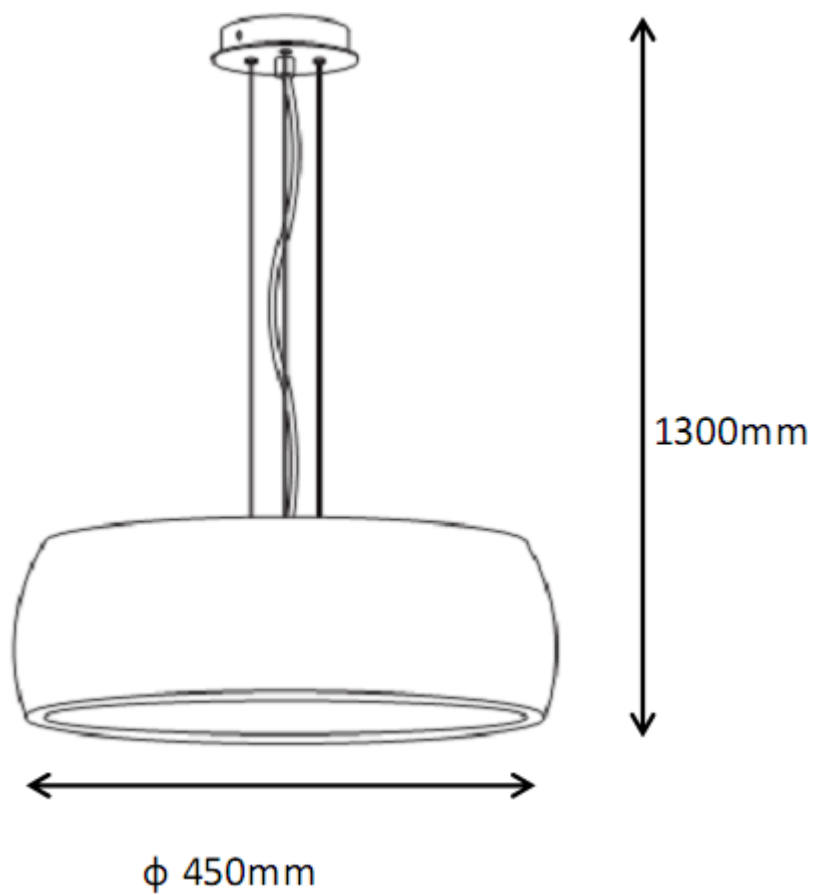

Line drawing of the item (with outline dimensions)



Item number: 31426/40/31

Installation drawing (the same as it in its instruction manual)

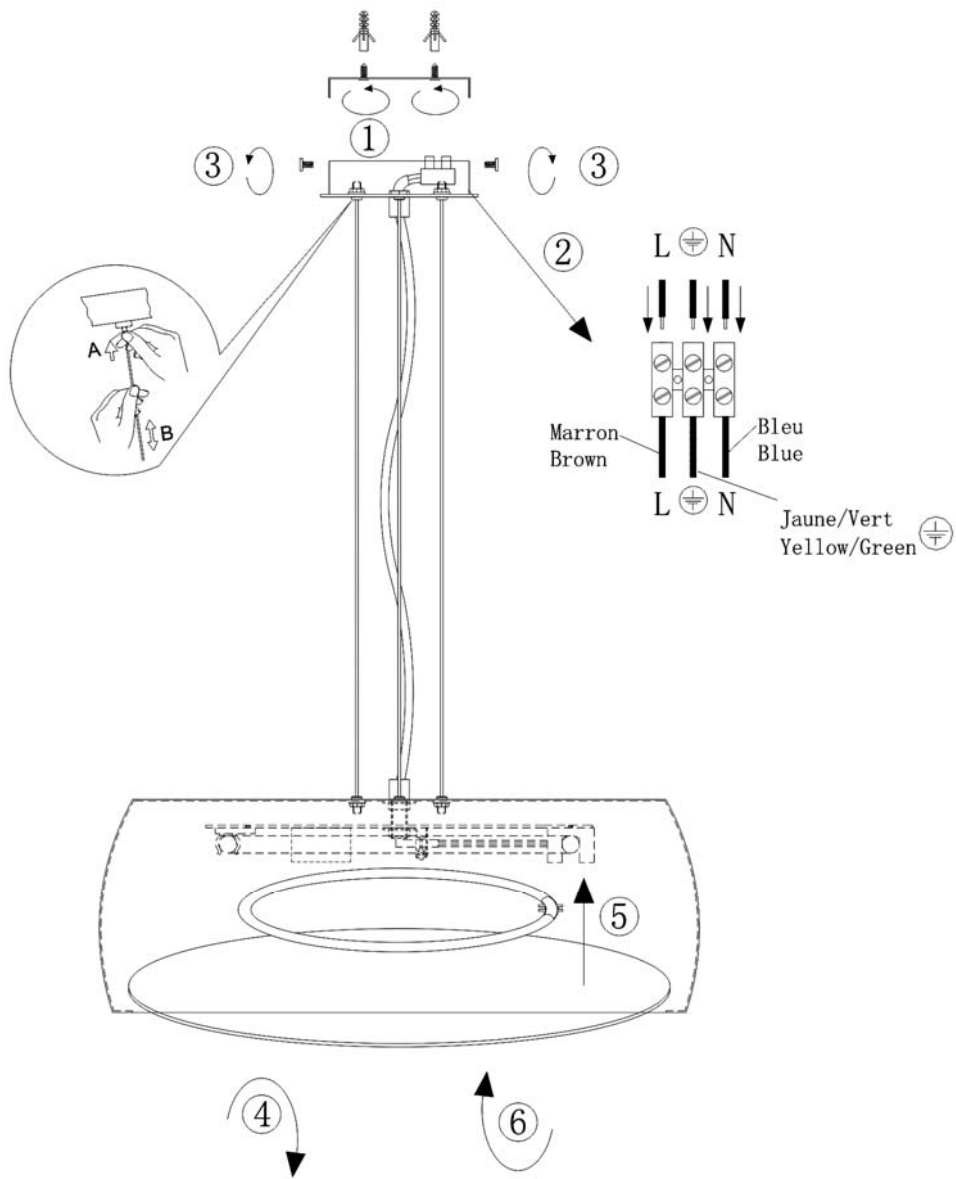

### Technical details

|   |                   |         |
|---|-------------------|---------|
| materials used:                           | Aluminium+acrylic |         |
| color:                                    | 31                | white   |
| dimnable and how is the fixture dimmable: |                   |         |
| size:                                     | Height:           | 130cm   |
|   | Length:           |         |
|   | Width:            | D45cm   |
|   | Net Weight:       | 2.4kgs  |
| power requirements:                       | 220-240V~50HZ     |         |
| bulb type and maximum Wattage:            | T5                | Max.40w |
| number of bulbs:                          | 1 x T5            |         |
| IP degree:                                | IP20              |         |

EES label (only one in English, vertical)

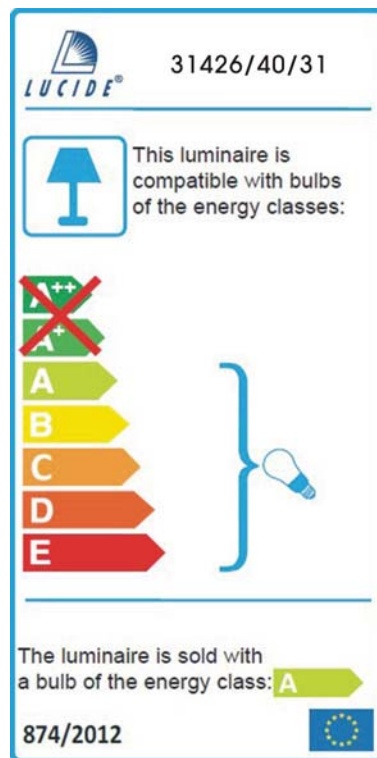

Lucide NV  
 Bisschoppenhoflaan 145  
 2100 Deurne  
 Belgium  
[info@lucide.be](mailto:info@lucide.be)  
 tel: +32 (0)3 366 22 04  
[www.lucide.be](http://www.lucide.be)